

# \$1,550,000 - 38259 Range Road 261 A, Rural Red Deer County

---

MLS® #A2146666

**\$1,550,000**

0 Bedroom, 0.00 Bathroom,  
Agri-Business on 0.00 Acres

NONE, Rural Red Deer County, Alberta

You might call this driving into paradise. Almost 85 acres with 50-55 acres in hay that you can cut, bale and store in the 40 x 160 hayshed. Plenty of corrals and shelters for the horses and then a 60 x 160 riding arena. Storage areas on both sides of arena. Also an upstairs common room / banquet room with full kitchen, washroom, tack room and couches to relax on and a wall full of windows to be able to watch the horse or cattle shows going on down below in the arena. A large shop area for keeping the tractors inside and doing maintenance. Could be an amazing place to build the home of your dreams that could be looking over the Red Deer River Valley, or board and train horses.

## Essential Information

MLS® #	A2146666
Price	\$1,550,000
Bathrooms	0.00
Acres	0.00
Type	Agri-Business
Sub-Type	Agriculture
Status	Active

## Community Information

Address	38259 Range Road 261 A
Subdivision	NONE

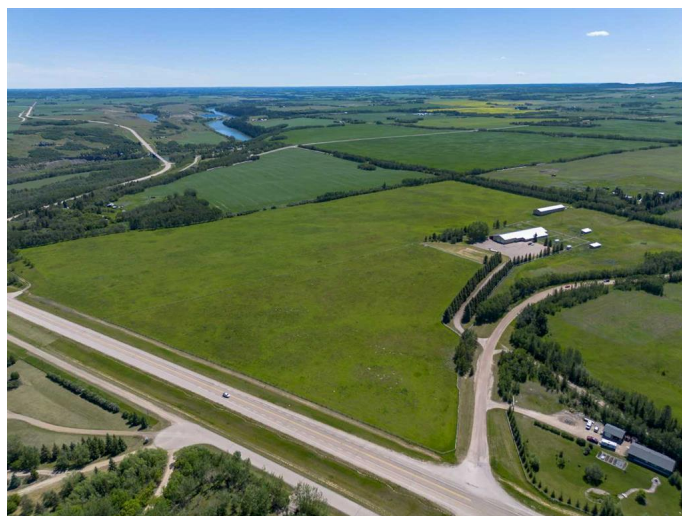

City	Rural Red Deer County
County	Red Deer County
Province	Alberta
Postal Code	T4E 0S8

**Interior**

Appliances	Refrigerator, Stove(s)
------------	------------------------

**Additional Information**

Date Listed	July 11th, 2024
Days on Market	339
Zoning	AG

**Listing Details**

Listing Office	Royal Lepage Network Realty Corp.
----------------	-----------------------------------

Data is supplied by Pillar 9â„¢ MLSÂ® System. Pillar 9â„¢ is the owner of the copyright in its MLSÂ® System. Data is deemed reliable but is not guaranteed accurate by Pillar 9â„¢. The trademarks MLSÂ®, Multiple Listing ServiceÂ® and the associated logos are owned by The Canadian Real Estate Association (CREA) and identify the quality of services provided by real estate professionals who are members of CREA. Used under license.